2023-24 NORTHEAST SECTIONAL TOURNAMENT

Algoma High School 1715 Division St. Algoma, WI

February 24, 2024

wisconsindi.org 



PINBALL HEROES
TECHNICAL

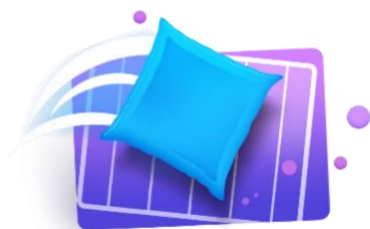

GOING THE DISTANCE
ENGINEERING



BLAST FROM THE PAST
SCIENTIFIC



IN MOTION
FINE ARTS



SO EXTRA
IMPROVISATIONAL

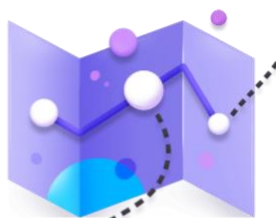

UNCHARTED
SERVICE LEARNING



MAKING A SPLASH
EARLY LEARNING



**INSTANT
CHALLENGE**



CHALLENGE EXPERIENCE

WELCOME

Good luck to all teams competing in the tournament!

Thank you to all of our Team Managers, teachers, school sponsors, Appraisers, volunteers, and parents for your hard work to make this tournament possible.

The top three Elementary Level teams, the top three Middle Level teams, and the top three Secondary Level teams in each Challenge will qualify to advance to the Wisconsin Affiliate Tournament being held in Green Bay on April 6, 2024.

Tournament Notes & Reminders

- Teams should report to their Challenge Prep Area 20 minutes before their scheduled Presentation time. Engineering teams report 30 minutes before.
- Spectators will NOT be allowed to enter the Presentation Area once a team's Presentation has begun.
- Teams are encouraged to trade pins as a way to meet new friends and show good sportsmanship. Make sure any wrappers are disposed of properly.
- Parents, spectators, and Team Managers: remember to respect the rules of Interference. Do not interfere with the team's solution.
- All teams should report to Fulwiler Fieldhouse for the Closing Ceremony at 4:00 p.m.

Acknowledgments

Northeast Sectional Tournament

Tim Hornberger, Regional Director, Green Bay Area DI
Tournament Director, Northeast Sectional
Jerry Borkovetz, Regional Director, BayLake
Tournament Director, Northeast Sectional
Jesse Brinkmann, Superintendent, Algoma School District

Robyn Harper, Regional Director, BayLake
Tournament Director, Northeast Sectional
Nicole Meverden, DI Coordinator, Algoma School District
Facilities Coordinator, Northeast Sectional
David Robertson, Principal, Algoma High/Middle School

Northeast Sectional Challenge Masters

Steve Rabach, Technical
Ileen Ross, Improvisational
Tim Ash, Engineering
Erin Dahle, Service Learning

Katie Hornberger, Scientific
Robyn Harper, Improvisational
Jerry Borkovetz, Engineering
Erin Dahle, Early Learning

Tracy Laude, Fine Arts
Elliott Kaas, Instant Challenge
Ryan Warwick, Engineering
Brett Warnimont, Affiliate Score Master

Wisconsin Destination Imagination Board of Directors & Staff

Mary Bykowski, Affiliate Director
Mikaela Becker, Affiliate Tournament Director/Alumni Relations
Coordinator
Anne Coulling, Secretary/Regional Director Seat
Elliott Kaas, Affiliate Challenge Master Seat

Michael Davis, Board Chair
Jill North, Affiliate Growth Director

Robyn Harper, Regional Director Seat/Social Media
Manager/Webmaster
Erika Frank Motsch, At Large Seat

A special thank you to the Algoma School District, faculty, and custodial staff for the use of the Algoma High School for our Sectional tournament! Thank you to the Algoma Music Boosters for providing today's concessions. Thank you to Moe's Corner for providing today's Appraiser lunch.

Release/Disclaimer

By my participation in an event conducted by an Affiliate, Region, or other gathering related to the Destination Imagination program, the participant or participant's parents or participant's guardian understands and hereby voluntarily agrees to release, waive, forever discharge, hold harmless, defend, and indemnify Destination Imagination, Inc. and its agents, officers, boards, volunteers, and employees from any and all liability and all claims, actions, or losses for bodily injury, property damage, wrongful death, loss of services, or otherwise which may arise out of the participant's participation in activities related to the Destination Imagination event, including travel to and from the event.

GENERAL SCHEDULE

Time	Event	Location
6:30 AM	Building Opens For Teams	Door D
6:30 AM	Main Prop Drop Off Opens	Drop Off Door O Storage Fulwiler Fieldhouse
7:00 AM - 3:00 PM	Algoma Music Boosters Concessions Open	AHS Cafeteria
8:00 AM	Challenge Presentations Begin	
9:00 AM - 4:00 PM	Souvenir Sales Open - Cash Only	Outside Fulwiler Fieldhouse
4:00 PM	Celebration Ceremony!	Fulwiler Fieldhouse

Reminders:

- **The main prop drop off area is through Door O located at the west side of the building. Approach this door from Feld St. then continue north to the parking lot. Teams can leave props in the Door O hallway while you park. Follow the hall to prop storage in Fulwiler Fieldhouse (main gym).**
- **Please do not park immediately in front of the Community Wellness Center** (west end of the parking lot).
- Team Challenge (TC): Teams should report to their Challenge Prep Area 20 minutes before their scheduled Presentation time. Engineering teams are to report 30 minutes before. Refer to the floor plan at the back of this program for directions.
- Instant Challenge (IC): Teams are to report to Room 201 to check in for IC 20 minutes before their scheduled IC time. Teams and Team Managers only in the IC area.
- Please remove all props and scenery from the school as soon as possible after the conclusion of the TC presentation.
- Help clean up Fulwiler Fieldhouse (main gym) prior to the start of the Celebration Ceremony.
- Spectators are not allowed in the Instant Challenge area. Please wait in the cafeteria near the TA DA! area and help your teams celebrate!
- The **elevator** is located between the Little Theater (114 West)) and the south entrance of Fulwiler Fieldhouse.
- Teams are asked to stay for the entire Celebration Ceremony and cheer for ALL the teams.



PINBALL HEROES TECHNICAL

TECHNICAL CHALLENGE

All Levels: Auxiliary Gym

Team Entrance: Door XX via Fulwiler Fieldhouse

Audience Entrance via the Wellness Center Lobby

Instant Challenge Check-in Room 201

- Design and build a pinball system through which a pinball moves and interacts with 3 machine modules.
- During the Presentation, move the pinball through the pinball system for as long as possible.
- Create and present an action/adventure story about a hero who goes on an extraordinary mission.
- Create and present two Team Choice Elements that show off the team's interests, skills, areas of strength, and talents.

Team #	Organization Name	Team Name	Team Challenge Prep Area Check In	Team Challenge Time	Instant Challenge Check-In Time	Instant Challenge Time
			Auxiliary Gym	Auxiliary Gym	Room 201	
Elementary Level						
148-02788	Unified School District of De Pere	The Creators	7:40 AM	8:00 AM	10:00 AM	10:20 AM
148-60715	Green Bay Area Public Schools	Aldo - Elementary - Technical	8:00 AM	8:20 AM	10:40 AM	11:00 AM
148-63805	Sevastopol	The Bouncy Bell Bottoms	8:20 AM	8:40 AM	11:00 AM	11:20 AM
148-71092	Unified School District of De Pere	The Tsunami Squad	8:40 AM	9:00 AM	12:20 PM	12:40 PM
Middle Level						
148-49144	Unified School District of De Pere	Phrases	9:20 AM	9:40 AM	12:40 PM	1:00 PM
Secondary Level						
148-44795	Algoma School District	DI-no Nuggets	9:40 AM	10:00 AM	1:00 PM	1:20 PM
148-10242	Shawano School District	6	10:00 AM	10:20 AM	1:40 PM	2:00 PM



GOING THE DISTANCE
ENGINEERING

ENGINEERING CHALLENGE
All Levels: Auxiliary Gym
Team Entrance: Door XX via Fulwiler Fieldhouse
Audience Entrance via the Wellness Center Lobby
Instant Challenge Check-in Room 201

- Design and build a modular device that will be assembled and then tested in two different configurations during the Presentation.
- Complete launch tests to test how far and how accurately your modular device can launch a bean bag in each configuration.
- Transform the modular device from one configuration to the other.
- Create and present a story in which everything is going according to plan until a catalyst occurs.
- Create and present two Team Choice Elements that show off the team’s interests, skills, areas of strength, and talents.

Team #	Organization Name	Team Name	Team Challenge Prep Area Check In	Team Challenge Time	Instant Challenge Check In Time	Instant Challenge Time
			Auxiliary Gym	Auxiliary Gym	Room 201	
Secondary Level						
148-52913	Unified School District of De Pere	The Dust Bunnies	10:30 AM	11:00 AM	2:00 PM	2:20 PM
148-89169	Sevastopol	The Ultimate Alchemists	10:50 AM	11:20 AM	2:20 PM	2:40 PM
Elementary Level						
148-28255	Green Bay Area Public Schools	The StacocatS	12:10 PM	12:40 PM	7:40 AM	8:00 AM
148-50076	Shawano School District	The Asteroids	12:30 PM	1:00 PM	8:00 AM	8:20 AM
148-62263	SCHOOL DISTRICT OF DENMARK	THE SHOCKWAVES	12:50 PM	1:20 PM	8:20 AM	8:40 AM
148-46688	Green Bay Area Public Schools	Aldo - Elementary - Monday	1:30 PM	2:00 PM	9:40 AM	10:00 AM
148-34079	Shawano School District	Funky Unicorns	1:50 PM	2:20 PM	9:20 AM	9:40 AM
148-67365	SCHOOL DISTRICT OF DENMARK	DENMARK FLYERS	2:10 PM	2:40 PM	8:40 AM	9:00 AM



BLAST FROM THE PAST
SCIENTIFIC

SCIENTIFIC CHALLENGE

All Levels: Little Theater Room 114

Team Entrance: Room 114 Southeast Entrance

Audience Entrance Room 114 West Entrance

Instant Challenge Check-in Room 201

- Create and present a story about a character whose discovery of an artifact leads to a finding.
- Include an archaeological investigation that contributes to the finding.
- Design and create a puppet that will portray a character from the past.
- Create and present two Team Choice Elements that show off the team's interests, skills, areas of strength, and talents.

Team #	Organization Name	Team Name	Team Challenge Prep Area Check In	Team Challenge Time	Instant Challenge Check In Time	Instant Challenge Time
			Little Theater Room 114 Southeast Entrance	Little Theater Room 114 West Entrance	Room 201	

Elementary Level

148-02113	Algoma School District	Donut You Know Our Name	8:40 AM	9:00 AM	10:20AM	10:40 AM
148-17885	Green Bay Area Public Schools	Aldo - Perlewitz	9:00 AM	9:20 AM	10:40 AM	11:00 AM
148-46279	Unified School District of De Pere	Dickinson Creators	9:20 AM	9:40 AM	1:40 PM	2:00 PM
148-99371	St. Paul Stevens Point	Society of Fuzzy Scaly Thingies	10:00 AM	10:20 AM	1:20 PM	1:40 PM

Middle Level

148-26556	Sevastopol	The Magix	10:20 AM	10:40 PM	12:00 PM	12:20 PM
148-75799	Waupaca School District	Time Travelers	10:40 AM	11:00 AM	8:20 AM	8:40 AM



SO EXTRA
IMPROVISATIONAL

IMPROVISATIONAL CHALLENGE

All Levels: Little Theater Room 114
Team Entrance: Room 114 Southeast Entrance
Audience Entrance Room 114 West Entrance

- Create and present a 2-act improvisational skit based on a scenario.
- Incorporate a stock character into the skit.
- Research costume design and use a costume design kit to create a costume.
- Use an intensifier to minimize or maximize the scenario, stock character, and costume.

Team #	Organization Name	Team Name	Team Challenge Prep Area Check In	Team Challenge Time	Instant Challenge Check In Time	Instant Challenge Time
			Little Theater Room 114 Southeast Entrance	Little Theater Room 114 West Entrance	Room 201	
Middle Level						
148-09427	Shawano School District	The Ummms	12:00 PM	12:20 PM	2:10 PM	2:30 PM
148-44561	Shawano School District	Pilgrims of Imagination	12:20 PM	12:40 PM	9:00 AM	9:20 AM
148-41601	Tosa DI	The Uncrustables	12:40 PM	1:00 PM	9:20 AM	9:40 AM
148-06311	Unified School District of De Pere	Cool Beans	1:00 PM	1:20 PM	10:20 AM	10:40 AM
Secondary Level						
148-53791	Algoma School District	Team Rocket	1:40 PM	2:00 PM	8:40 AM	9:00 AM
Elementary Level						
148-59794	Unified School District of De Pere	Legendary GOATs	2:00 PM	2:20 PM	9:00 AM	9:20 AM
148-61404	Unified School District of De Pere	Thy SnakRs	2:20 PM	2:40 PM	9:20 AM	9:40 AM



IN MOTION
FINE ARTS

FINE ARTS CHALLENGE
Elementary Level Room 215
Audience Entrance Room 215
Team Entrance Room 214

- Create and present a story inspired by a work of visual art.
- Include a static character and a dynamic character in the story.
- Reimagine the work of visual art as performance art and include the reimagined art in the Presentation.
- Design and create one piece of kinetic art that uses technical methods to create movement.
- Create and present two Team Choice Elements that show off the team's interests, skills, areas of strength, and talents.

Team #	Organization Name	Team Name	Team Challenge Prep Area Check In	Team Challenge Time	Instant Challenge Check In Time	Instant Challenge Time
			Room 214	Room 215	Room 201	
Elementary Level						
148-84032	Seymour Community School District	Thunder Sisters	8:20 AM	8:40 AM	9:40 AM	10:00 AM
148-43182	Waupaca School District	The Cave Cats	8:40 AM	9:00 AM	10:00	10:20 AM
148-93957	SCHOOL DISTRICT OF DENMARK	WATERMELON BEACH BABES	9:00 AM	9:20 AM	10:40 AM	11:00 AM
148-36137	Algoma School District	Algoma Rocks	9:20 AM	9:40 AM	11:00 AM	11:20 AM
148-24952	Shawano School District	Cra Ha Ha Zants	10:20 AM	10:40 AM	12:40 PM	1:00 PM
148-32870	Unified School District of De Pere	The Smarties	10:40 AM	11:00 AM	2:00 PM	2:20 PM
148-86870	Unified School District of De Pere	You Will Never Kn?w	11:00 AM	11:20 AM	1:00 PM	1:20 PM
148-28597	Green Bay Area Public Schools	Aldo - Chess Squad - Art	11:20 AM	11:40 AM	2:20 PM	2:40 PM
148-71972	Waupaca School District	The Flaming Hot Cheetos	12:40 PM	1:00 PM	10:20 AM	10:40 AM
148-50964	Shawano School District	The Exploding Blueberries	1:00 PM	1:20 PM	8:40 AM	9:00 AM



IN MOTION
FINE ARTS

FINE ARTS CHALLENGE

**Middle & Secondary Levels
Room 216**

Team Entrance Room 213

Audience Entrance Room 216

- Create and present a story inspired by a work of visual art.
- Include a static character and a dynamic character in the story.
- Reimagine the work of visual art as performance art and include the reimagined art in the Presentation.
- Design and create one piece of kinetic art that uses technical methods to create movement.
- Create and present two Team Choice Elements that show off the team's interests, skills, areas of strength, and talents.

Team #	Organization Name	Team Name	Team Challenge Prep Area Check In	Team Challenge Time	Instant Challenge Check In Time	Instant Challenge Time
			Room 213	Room 216	Room 201	
Middle Level						
148-15450	Seymour Community School District	The Amigos	8:20 AM	8:40 AM	9:40 AM	10:00 AM
148-73858	Seymour Community School District	5 Ferocious Females	8:40 AM	9:00 AM	10:00 AM	10:20 AM
148-56024	Waupaca School District	The Awkward Silence	9:00 AM	9:20 AM	10:40 AM	11:00 AM
148-41573	Sevastopol	The 7 Puppeteers	10:00 AM	10:20 AM	12:40 PM	1:00 PM
148-88815	Green Bay Area Public Schools	Aldo - MS - The Best Team - Mon	10:20 AM	10:40 AM	1:00 PM	1:20 PM
148-99483	Waupaca School District	Waupaca Warriors	10:40 AM	11:00 AM	1:20 PM	1:40 PM
Secondary Level						
148-15252	SCHOOL DISTRICT OF DENMARK	THE MISCREANT MIQ'S	11:00 AM	11:20 AM	1:40 PM	2:00 PM



MAKING A SPLASH
EARLY LEARNING

EARLY LEARNING CHALLENGE
Audience Entrance 107
Team Entrance 105

- Research underwater habitats.
- Create and present a play about a group of underwater creatures who go on vacation to an underwater habitat.
- Design and build a model of a landmark the underwater creatures visit.
- Create scenery to show the underwater habitat.
- Create and present one Team Choice Element that shows off the team’s interests, skills, areas of strength, and talents.

Team #	Organization Name	Team Name	Team Challenge Prep Area Check In	Team Challenge Time	Instant Challenge Check In Time	Instant Challenge Time
			Room 105	Room 107	Room 201	
148-76459	Green Bay Area Public Schools	Aldo - Rising Stars - Ard	8:40 AM	9:00 AM		
148-19944	Shawano School District	Ocean Bluez	9:00 AM	9:20 AM		
148-83239	Shawano School District	Aqua-Stars!	9:20 AM	9:40 AM		
148-89559	Shawano School District	The Underwater Adventurers	10:00 AM	10:20 AM		
148-65382	St. Paul Stevens Point	St. Paul Sea Stars	10:20 AM	10:40 AM		
148-15732	Waupaca School District	Flaming Hot Takis	10:40 AM	11:00 AM		

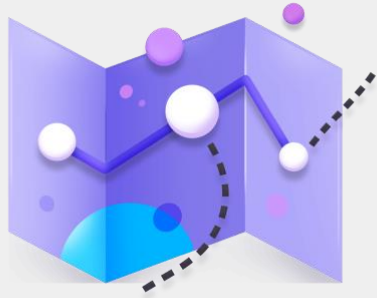

UNCHARTED
SERVICE LEARNING

SERVICE LEARNING CHALLENGE

Audience Entrance 107

Team Entrance 105

- Identify, design, carry out, and evaluate a project that addresses a need in a real community.
- Create and present a fantasy story about a character who goes on a quest.
- Design and create a fantasy map that uses technical methods to represent location information from the story.
- Create and present two Team Choice Elements that show off the team's interests, skills, areas of strength, and talents.

Team #	Organization Name	Team Name	Team Challenge Prep Area Check In	Team Challenge Time	Instant Challenge Check In Time	Instant Challenge Time
			Room 105	Room 107	Room 201	
Middle Level						
148-24514	Shawano School District	Glossy Treats	12:00 PM	12:20 PM	2:40 PM	3:00 PM
148-30904	Shawano School District	The Plungering Pirates	12:20 PM	12:40 PM	2:20 PM	2:40 PM
148-70394	Green Bay Area Public Schools	Aldo - MS - SL	12:40 PM	1:00 PM	8:40 AM	9:00 AM
148-07914	St. Paul Stevens Point	Fantastic Fantasy Floofballs	1:20 PM	1:40 PM	9:40 AM	10:00 AM
148-28769	Waupaca School District	Kok-A-Do-Da-Doodles	1:40 PM	2:00 PM	10:00 AM	10:20 AM
Elementary Level						
148-98524	Algoma School District	Big Feet Monkeys	2:20 PM	2:40 PM	9:00 AM	9:20 AM
148-25200	Green Bay Area Public Schools	Aldo - Trash Pandas – SL	2:40 PM	3:00 PM	9:20 AM	9:40 AM



Vision

Ignite the power of ALL youth to be the creative and collaborative innovators of tomorrow

Mission

To inspire and equip youth to imagine and innovate through the creative process

New to DI? Welcome!

We're glad you're here! There's no better way to understand the Destination Imagination Challenge Experience than to see it in action. To get the most out of your day at this tournament, here's what we suggest:

- Attend at least one Presentation in every Team Challenge. Each Team Challenge is unique and has open-ended requirements, allowing teams to create totally different solutions from one another. Read through the Points of Interest so you know what you can expect to see. Each Presentation is around eight minutes in length.
- Wish the teams luck in their Instant Challenge. All of our teams participate in an Instant Challenge as part of their tournament experience, during which they use quick, creative and critical thinking, and teamwork to come up with a solution in a short amount of time. Spectators are not allowed in these presentations as the Instant Challenges themselves are highly confidential.
- Look at the props, costumes, sets, technical devices and more that the teams have created—but please don't touch! Remember that everything you see was crafted by the team members with no adult interference.
- Talk to teams, parents and volunteers about their experience with this season of Destination Imagination. Tell them you're considering starting a team, and ask them to share their favorite thing about DI—you'll be amazed by the different answers you hear.
- Have fun, be inspired, and imagine the possibilities!

Learn more at DestinationImagination.org. Sign up for our newsletter for all the latest updates and to be alerted when registration is open for the 2024-25 season.

Learn more at DestinationImagination.org

2024-25 CHALLENGE PREVIEWS



BREAKING POINT TECHNICAL

Build it up and knock it down! In this Challenge, your team will go from the highest heights to the lowest lows as you use team-created equipment to build and destroy stacks of items. What will a character do when their greatest wishes encounter a frustration point? Will it all come tumbling down? Find out in this season's Technical Challenge!

- Design and build assembly equipment and destruction equipment.
- Use the assembly equipment to create a stack of items.
- Use the destruction equipment to disassemble and/or destroy the stack.
- Create and present a story about a character who lacks something important and attempts to gain it.
- Create and present two Team Choice Elements that show off the team's interests, skills, areas of strength, and talents.



HIGH-WIRE ACT ENGINEERING

Come one, come all to the greatest show on Earth! Join us for a daring feat of high-wire innovation as you test a transporter that will carry weights along a tournament-provided cord. Present a story in the style of contemporary circus and don't forget to include a daring display! This season's Engineering Challenge isn't clowning around!

- Design and build a transporter that will be tested during the team's Presentation.
- Complete weight transport tests to test how much weight the transporter can carry along a tournament-provided cord at various angles.
- Create and present a story in the style of contemporary circus.
- Include a daring display and an ensemble spectacle in the Presentation.
- Create and present two Team Choice Elements that show off the team's interests, skills, areas of strength, and talents.



WORLDS BEYOND SCIENTIFIC

Space, the final frontier...join us for this season's Scientific Challenge as you explore the cosmos. Your team will tell a story about a character who figures out they are not alone on a planet. Show off your science fiction skills with some out-of-this-world technobabble. What will happen when you go beyond the stars?

- Create and present a story in which a character who is located on a planet other than Earth thinks they are alone but discovers that they are not.
- Include technobabble in the story.
- Design and build a device and/or effect that demonstrates what the technobabble describes.
- Include a scientific demonstration that shows the science behind why a specific phenomenon of the planet happens and/or exists.
- Create and present two Team Choice Elements that show off the team's interests, skills, areas of strength, and talents.



LESS IS MORE FINE ARTS

How can the simplest of things convey the most? Your team will tell a story about something small that can have a big impact and move the audience with an emotional moment. Be strategic with your use of color and shape as you design a big visual impact with your set. It's time to explore minimalism in this season's Fine Arts Challenge!

- Create and present a story about how something small and/or simple can create a big impact.
- Include a focal character in the story.
- Include an emotional moment in the story.
- Design and create a minimalist set.
- Create and present two Team Choice Elements that show off the team's interests, skills, areas of strength, and talents.

2024-25 CHALLENGE PREVIEWS



ARE WE THERE YET? IMPROVISATIONAL

From beginning to end, we must travel a path to get where we want to go! Use your improvisational skills to tell a story about a character traveling between two locations. Include a character who is trying to find something and a detour that causes an unforeseen change in the plan or route. It's time to hit the road with this season's Improvisational Challenge!

- Create and present an improvisational skit about a traveling character.
- Research locations and show the character's route between a starting location and an ending location.
- Research modes of transportation and incorporate one into the skit.
- Include a seeker and a detour in the skit.



THIS OR THAT SERVICE LEARNING

Left or right, apple or orange, smile or frown...the world is full of choices! Your team will tell a story about a character who must make a critical choice after considering potential outcomes. A binary device will enhance your Presentation by completing two tasks at once! Where will your decisions lead in this season's Service Learning Challenge?

- Identify, design, carry out, and evaluate a project that addresses a need in a real community.
- Create and present a story about a character who must make a critical choice.
- Include at least two potential outcomes and a complication in the story.
- Include a device that completes two different tasks from the same initiation in the Presentation.
- Create and present two Team Choice Elements that show off the team's interests, skills, areas of strength, and talents.



WEATHER TOGETHER EARLY LEARNING

Rain, snow, wind, sun, and hail! There are so many different kinds of weather and lots of wonderful activities that can only be done during the perfect kind of weather. Your team will tell a story about a character who is learning about one kind of weather for the very first time. It's a great day for some outdoor fun!

- Research different kinds of weather.
- Create and present a play about a character learning about a kind of weather for the very first time.
- Include a teacher character and a special weather activity in the story.
- Design and create a weather costume and a weather special effect.
- Create and present one Team Choice Element that shows off the team's interests, skills, areas of strength, and talents.



INSTANT CHALLENGE

Instant Challenges require teams to engage in quick, creative, and critical thinking. At a tournament, a team will receive an Instant Challenge and the materials with which to solve it.

- The team members must think on their feet by applying appropriate skills to produce a solution in a period of just five to eight minutes.
- Instant Challenges are performance-based, task-based, or a combination of the two.
- Although each Instant Challenge has different requirements, all Instant Challenges reward teams for their teamwork.
- Instant Challenges are kept confidential until the day of the tournament.

2023-2024 DI Northeast Sectional Tournament Map of Algoma High School

First Floor



Challenge A
Technical
Pinball Heroes



Challenge E
Engineering
Going the
Distance

Feld St.

Prop Drop Off
Vehicle Direction

Team Prop
Entrance
Door O

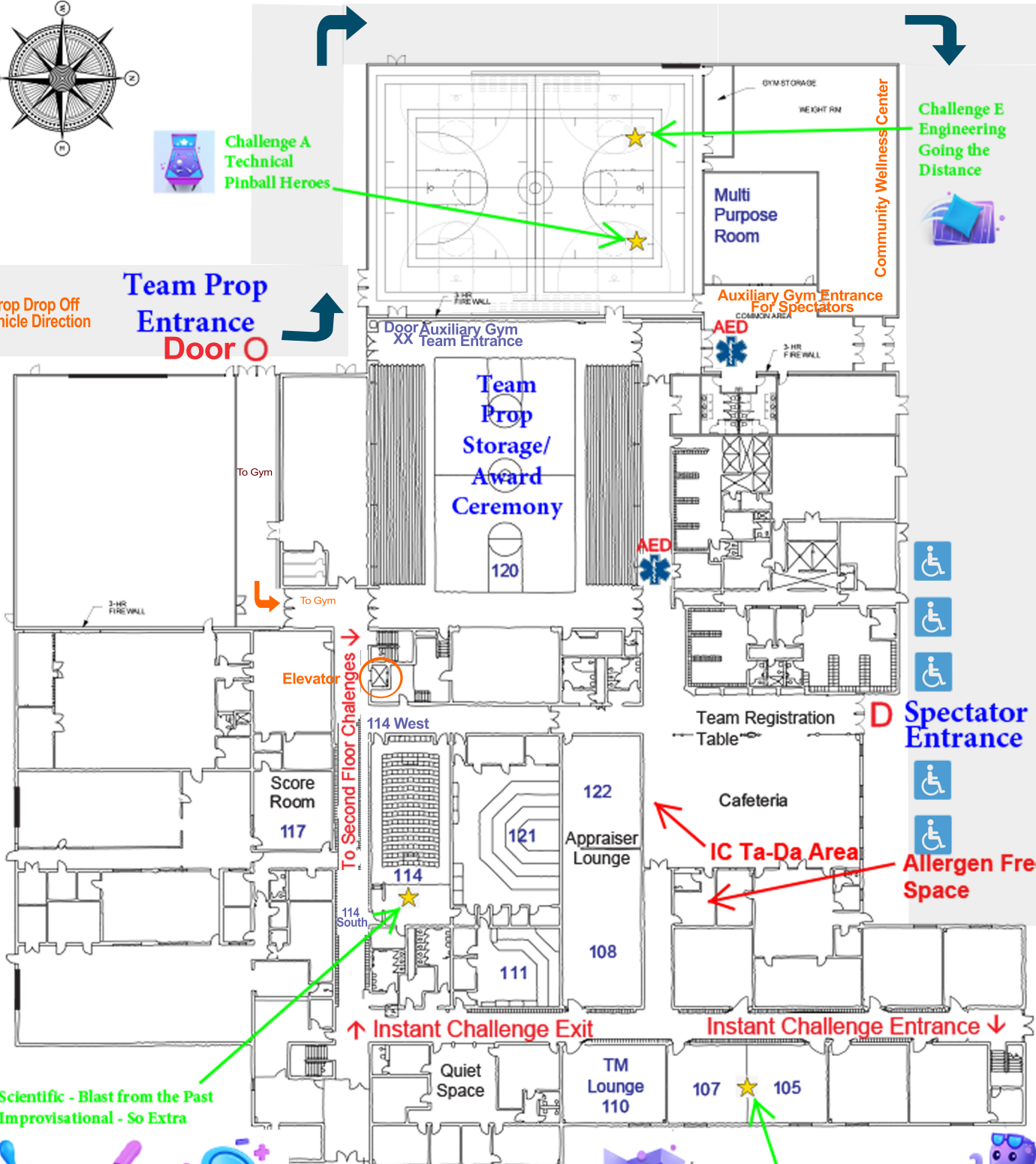

Scientific - Blast from the Past
Improvisational - So Extra



Instant Challenges are
on the second floor
Teams/Team Managers only



Service Learning - Uncharted
Early Learning - Making a Splash



 Elevator

Prop Drop Off: Inside Door O there is a hallway where props can be left while you park. Follow the hallway to Fulwiler Fieldhouse.

1715 Division St.

Main Parking
Entry/Exit

Parking



2023-2024 DI Northeast Sectional Tournament Map of Algoma High School Second Floor

