



2024 Affiliate Tournament

Building Floor Plans

Kress Events Center

- Interactive Expo
- Engineering Challenge
- Celebration Ceremony

Brown Co. STEM Building

- Technical Challenge

Wood Hall

- Scientific Challenge
- Service Learning Challenge

Mary Ann Cofrin (MAC) Hall

- Improv Challenge (1st flr)
- Fine Arts Challenge (2nd flr)
- Instant Challenge (2nd flr)

Your University Union

FOOD

| | |
|----------------------------|------|
| Common Grounds Coffeehouse | 229 |
| Leona Cloud Commons | 210 |
| Marketplace | 240 |
| Phoenix Club Concessions | 105A |
| Point Sable Room | 210E |
| Red Banks Room | 210D |
| Nicolet Room | 206 |
| Lower Level Dining | 107 |

LOUNGE SPACES

| | |
|----------------------------|---------|
| Niagara Lounge | 149 |
| Common Grounds Coffeehouse | 229 |
| Commuter Lounge | 131 |
| Leona Cloud Commons A | 210A |
| Phoenix Club | 105/109 |
| Esports Lounge | 109B |
| Timber Lounge | 200J |

Union: Food & Drink Venues

 Bathroom

 Food

SERVICES

| | |
|------------------------------------|-----|
| The Phoenix Bookstore | 205 |
| University Ticketing & Info Center | 203 |
| University Reservations | 306 |
| Starz Barber & Beauty | 232 |
| UW Credit Union | 201 |

STUDENT GOVERNMENT ASSOCIATION

| | |
|--|------|
| Executive Office | 151A |
| Senate | 151B |
| Residence Hall & Apartment Association | 151C |
| Student Banner Work Room | 151D |
| Segregated University Fee Allocation Committee | 151E |

FIRST FLOOR



SECOND FLOOR

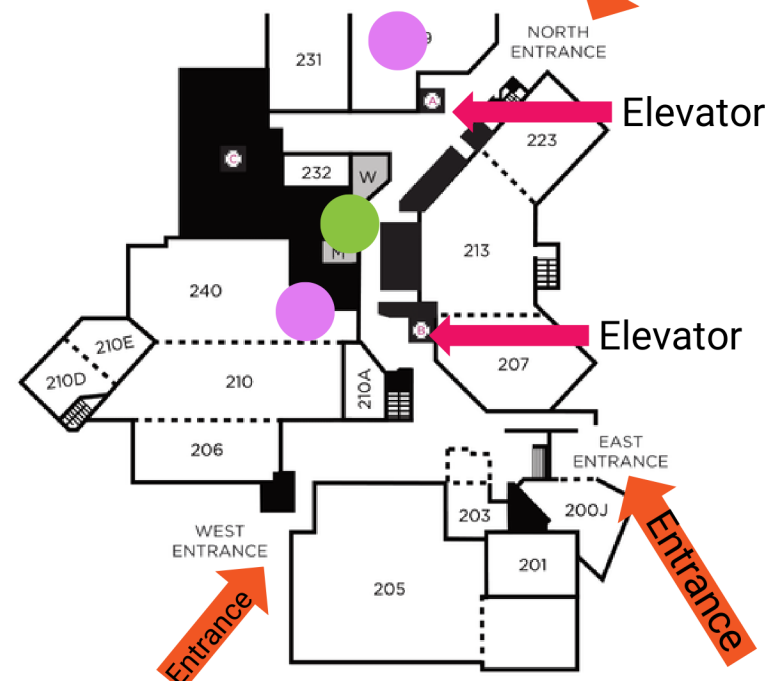

THIRD FLOOR

UNIVERSITY UNION ADMINISTRATION & STAFF OFFICES



Elevators - Floors 1, 2, & 3



Elevators - Floors 1 & 2 only



Freight Elevators - Floors 1 & 2 only

M - Men's Restroom
W - Women's Restroom
GI - Gender Inclusive Restroom



All University Union Restrooms are ADA Accessible

KRESS EVENTS CENTER BUILDING FLOOR PLAN

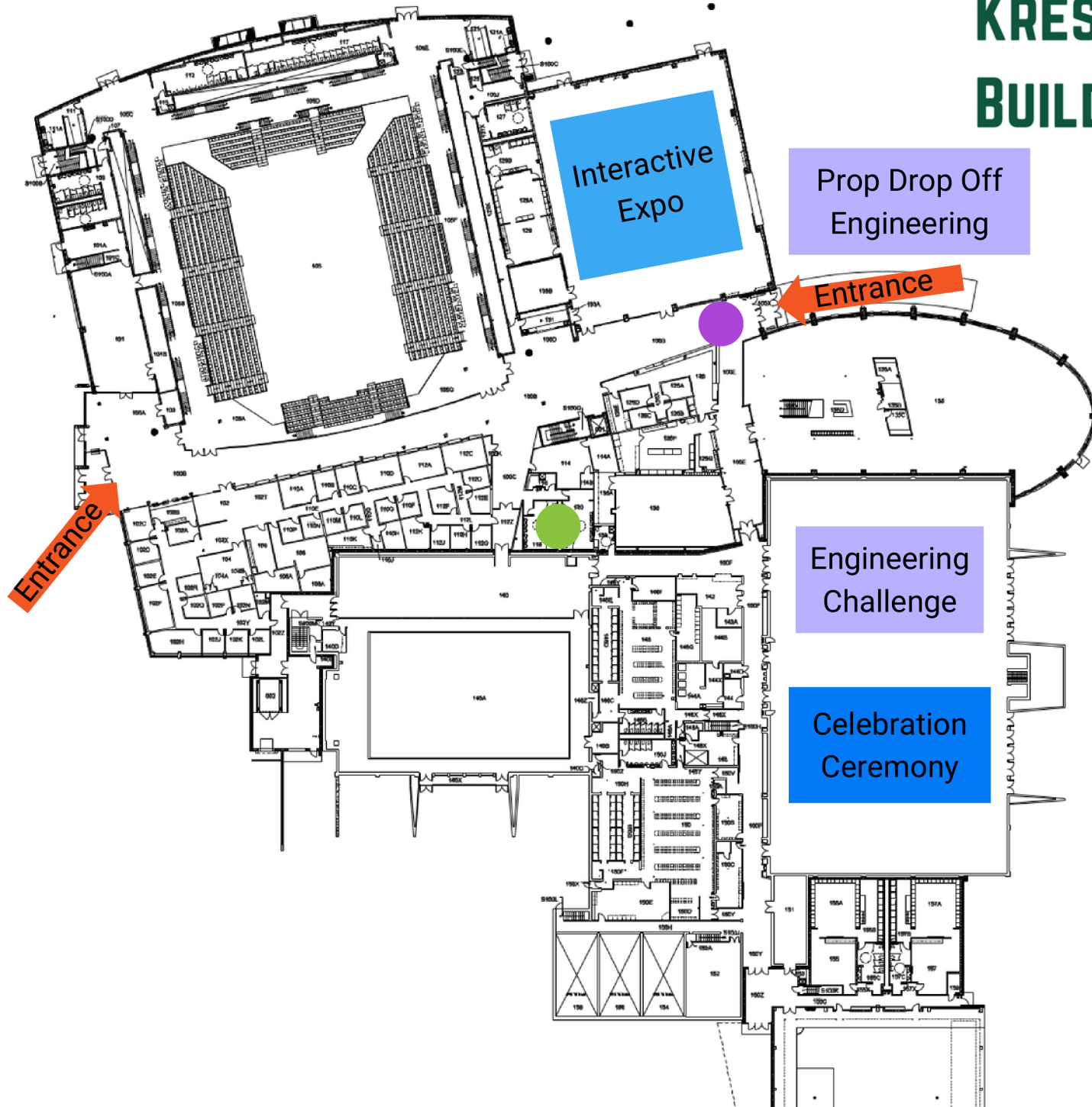

Information

Bathroom

Food



GOING THE DISTANCE
ENGINEERING

STEM BUILDING FLOOR PLAN

- BROWN COUNTY
- EINSTEIN PROJECT
- UW-GREEN BAY
- COMMON SPACES
- SHARED SPACES

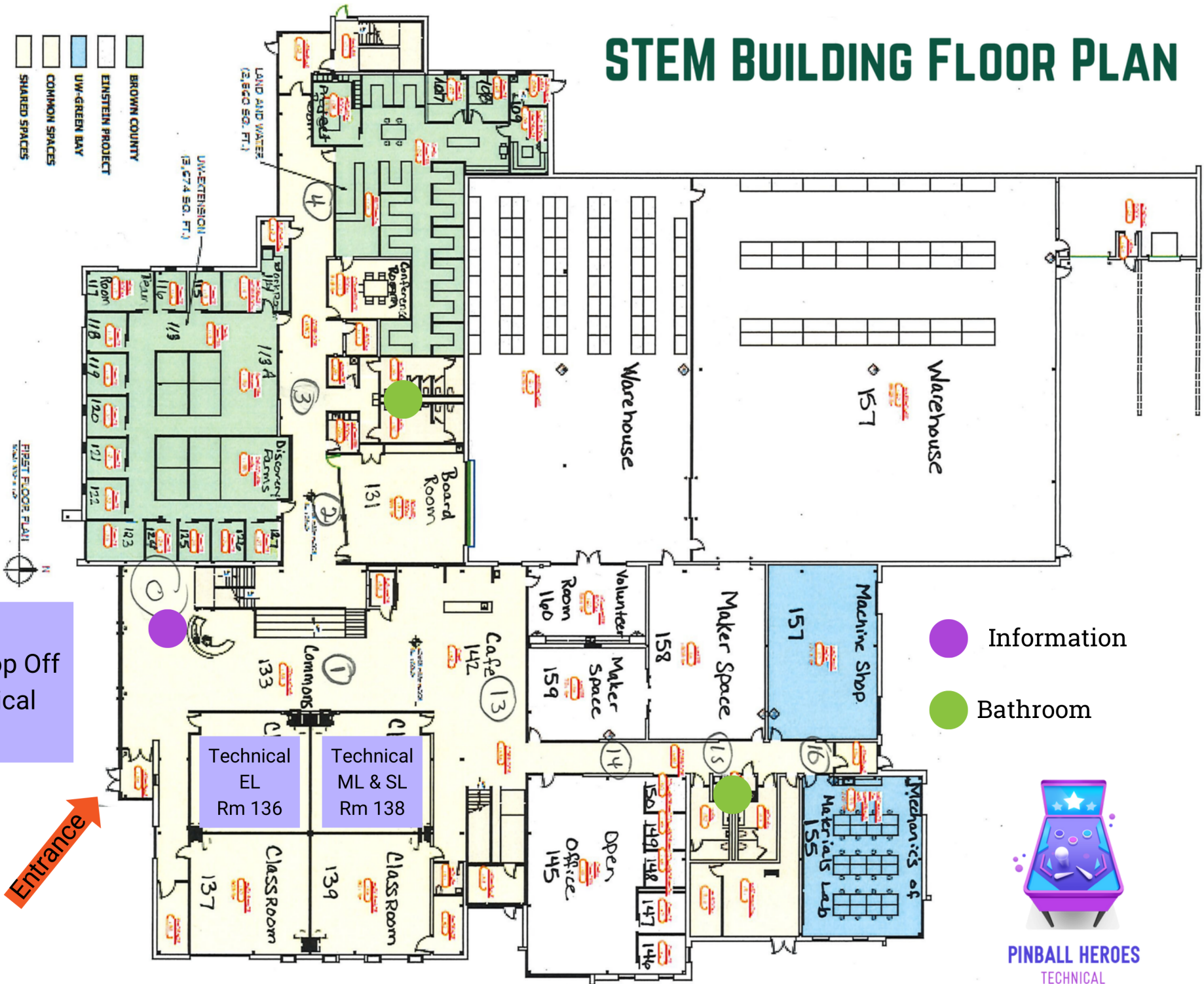

- Information
- Bathroom



PINBALL HEROES
TECHNICAL

WOOD HALL BUILDING FLOOR PLAN (1)

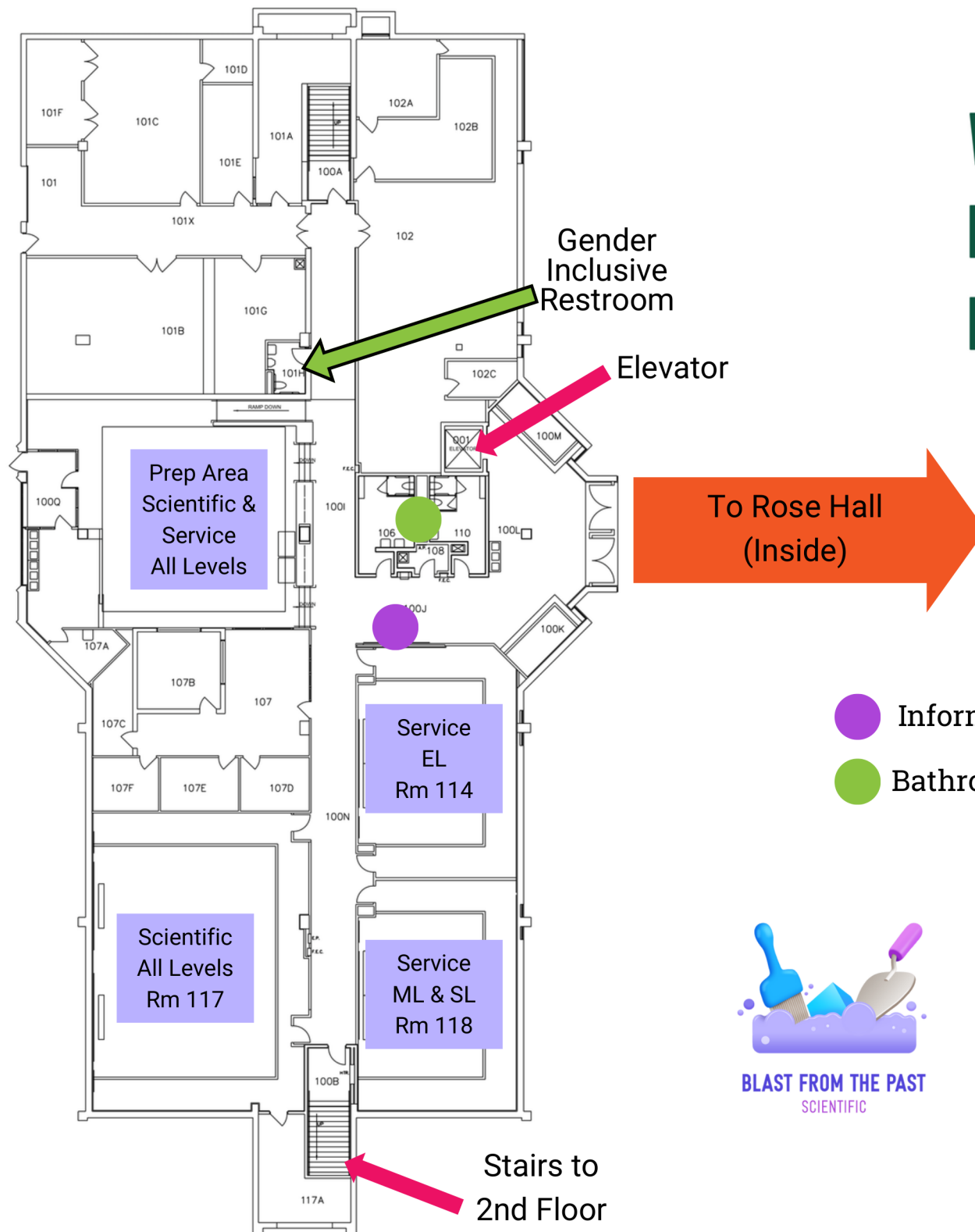

● Information

● Bathroom



BLAST FROM THE PAST
SCIENTIFIC



UNCHARTED
SERVICE LEARNING

MAC BUILDING FLOOR PLAN (1) 1st Floor

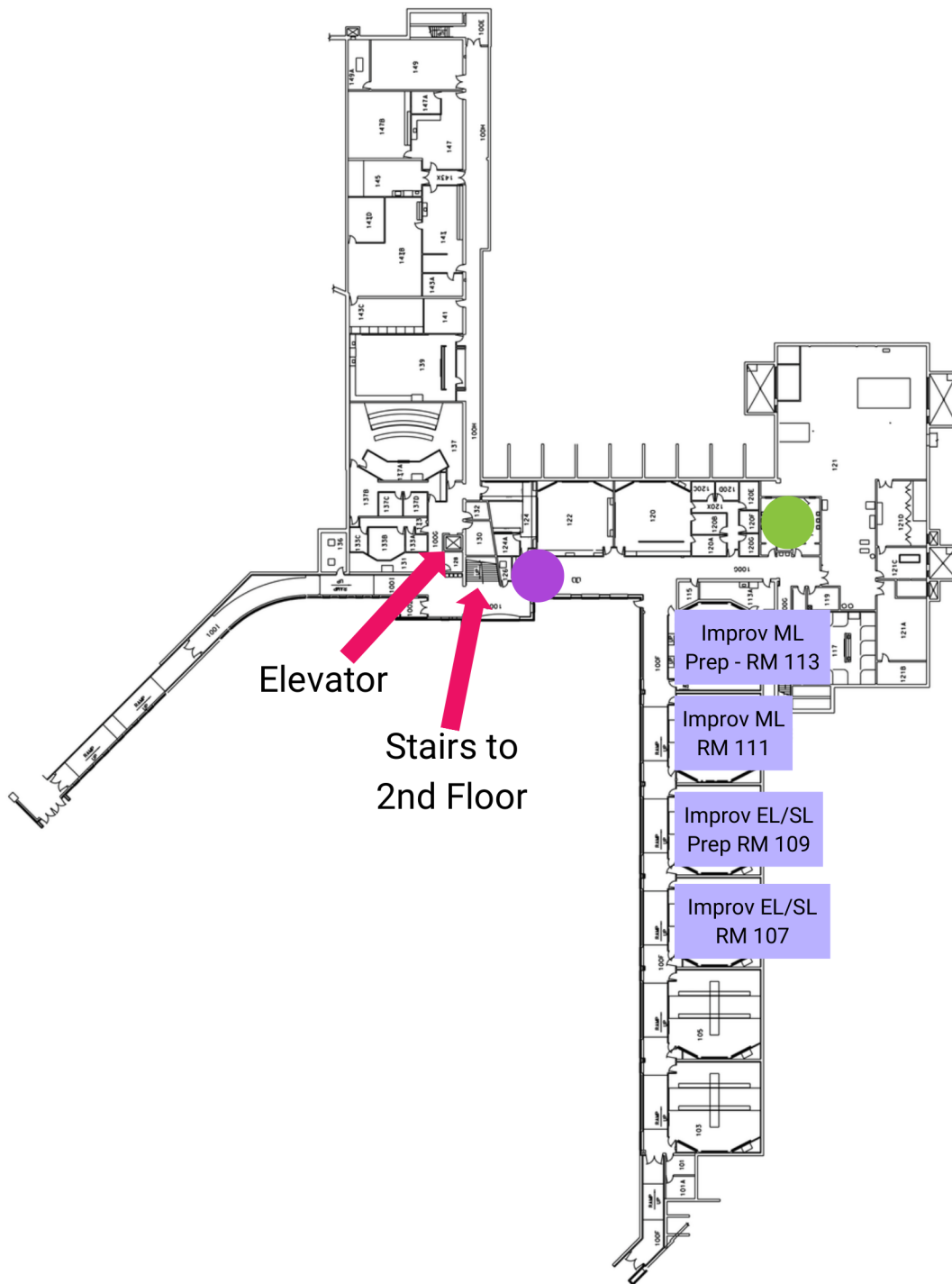

-  Information
-  Bathroom



SO EXTRA
IMPROVISATIONAL

MAC BUILDING FLOOR PLAN (2)

2nd Floor

-  Information
-  Bathroom
-  Instant Challenge TA-DA Area



IN MOTION
FINE ARTS



INSTANT
CHALLENGE

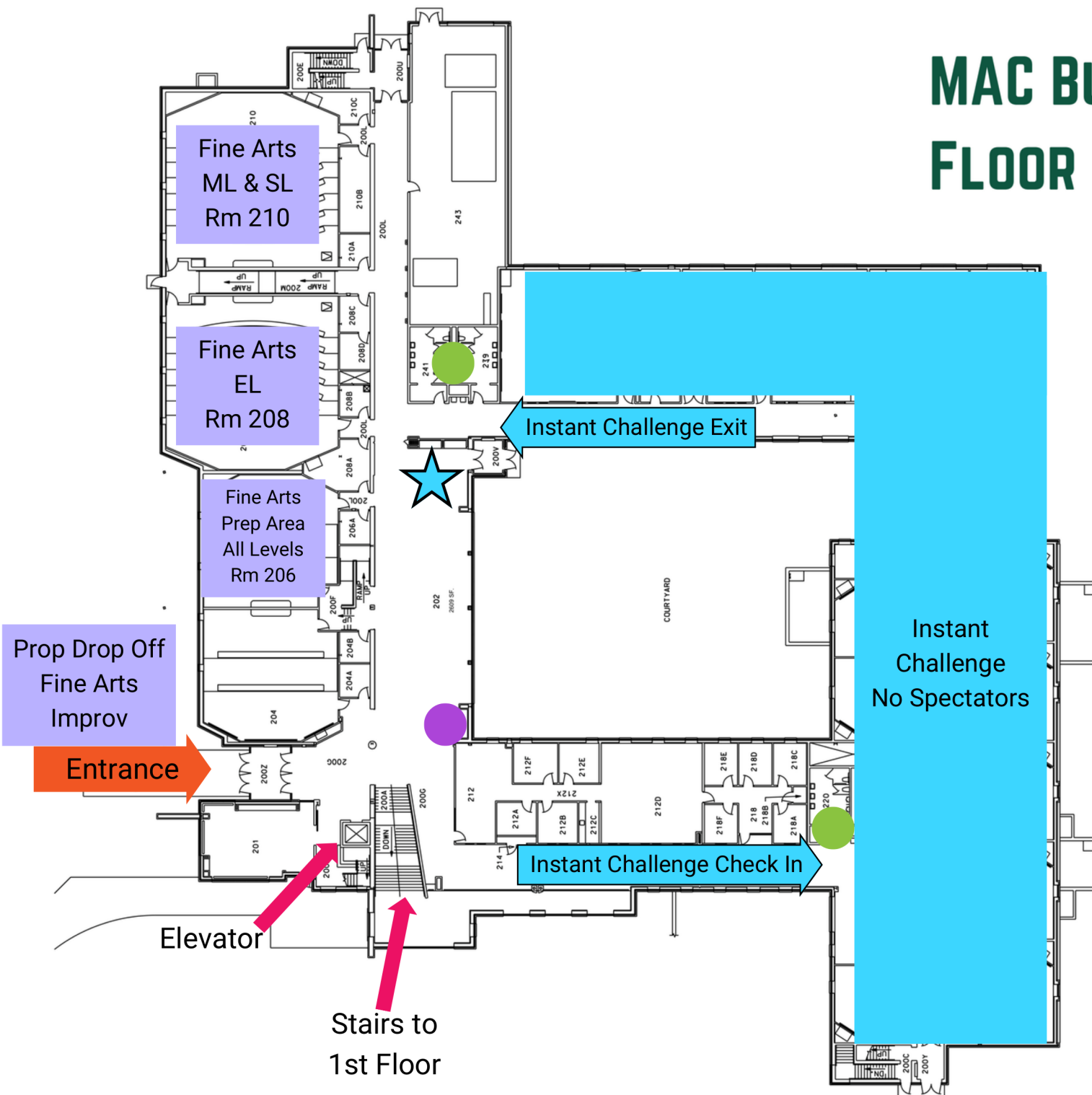

Tournament Day Parking

Parking is available in campus lots marked in yellow for Destination Imagination participants and their guests. Parking is not permitted in any housing or apartment parking lots.



Prop Drop Off Areas
(15 minutes with flashers on)



Parking (Trailer and bus parking available in Wood Hall Lot)

Dining Locations

- 4 Common Grounds
2nd Floor, University Union
Open 9am-7pm
- 4 The Marketplace
2nd Floor, University Union
Open 10am-7pm
- 17 Kress Events Center Kiosk
1st Floor, Kress Center
Open 7am-4pm

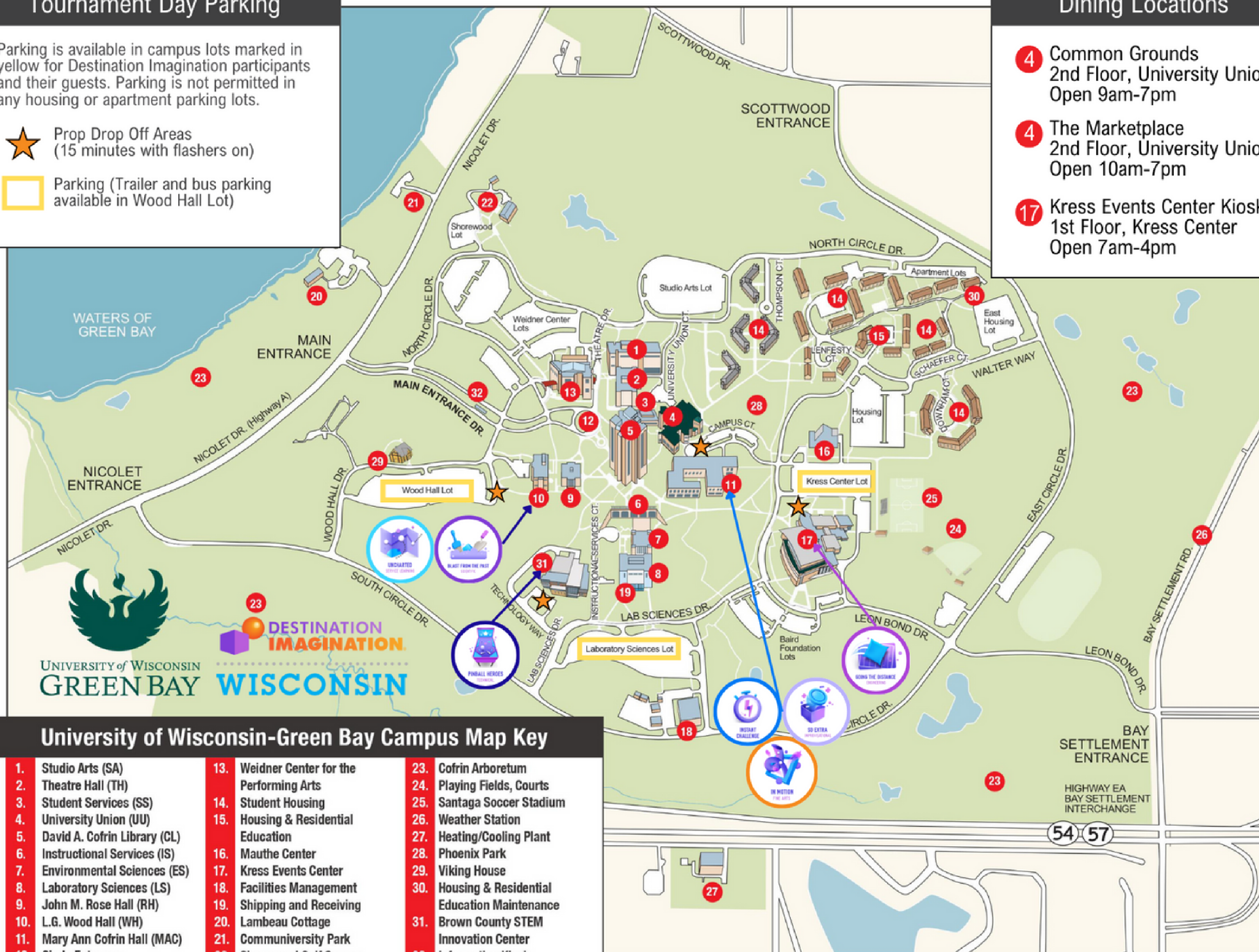

University of Wisconsin-Green Bay Campus Map Key

- | | | |
|---------------------------------|--|---|
| 1. Studio Arts (SA) | 13. Weidner Center for the Performing Arts | 23. Cofrin Arboretum |
| 2. Theatre Hall (TH) | 14. Student Housing | 24. Playing Fields, Courts |
| 3. Student Services (SS) | 15. Housing & Residential Education | 25. Santaga Soccer Stadium |
| 4. University Union (UU) | 16. Mauthe Center | 26. Weather Station |
| 5. David A. Cofrin Library (CL) | 17. Kress Events Center | 27. Heating/Cooling Plant |
| 6. Instructional Services (IS) | 18. Facilities Management | 28. Phoenix Park |
| 7. Environmental Sciences (ES) | 19. Shipping and Receiving | 29. Viking House |
| 8. Laboratory Sciences (LS) | 20. Lambeau Cottage | 30. Housing & Residential Education Maintenance |
| 9. John M. Rose Hall (RH) | 21. Communiiversity Park | 31. Brown County STEM Innovation Center |
| 10. L.G. Wood Hall (WH) | 22. Shorewood Golf Course | 32. Information Kiosk |